

W O R L D ' S G R E A T E S T T O N E A R M



KLAUDIO

KD-ARM-AP12 / User Manual

User Manuals are updated regularly. Please be sure to check our support page for a newer version of this guide: www.klaudio.com

NOTICE

Please read this manual carefully before using your Klaudio product.

ABOUT SIGNS

Throughout this document, critical information is highlighted in yellow-colored boxes. The following symbols are intended to help prevent any situation which may cause personal injury and/or damage to equipment:



WARNING: Indicates a potentially hazardous situation which, if not avoided, could result in personal injury or be life-threatening.



CAUTION: Indicates a potentially hazardous situation which, if not avoided, may result in damage to equipment or property.



PROHIBITED: Indicates a prohibited action.



CAUTION: This product contains a Class IIIa laser. Do not look directly into the beam, point the laser toward any person or vehicle, dismantle the laser, or view it with optically telescopic devices.

| Table of Contents

Package Contents	Page 3
<Setup>	
Tonearm Base Mounting	Page 4
Connecting Cables	Page 5
Connecting Laser	
VTA Preset	
Alignment Tool Installation	Page 6
Coarse (Height) Adjustment	
Laser Setting	Page 7
Setting Tonearm Horizontal Level	Page 8
Tonearm Length Adjustment	
Tracking Force Setting	
VTA Setting / Lift Height Adjustment	Page 9
Setting Support Clips	Page 10
Limited Warranty	

| TRADEMARKS

The Klaudio name and logo are trademarks or registered trademarks of Koolance, Inc. Other company and product names used in this publication are for identification purposes only and may be trademarks or registered trademarks of their respective companies.

| COPYRIGHT

All rights reserved. Copyright (C) Klaudio.

| CONTACT INFORMATION

Customer Support: tech@klaudio.com

Web: www.klaudio.com

Address: 2840 W Valley Hwy N, Ste. 101, Auburn, WA 98001, USA

Phone: +01 253-249-7813

Package Contents

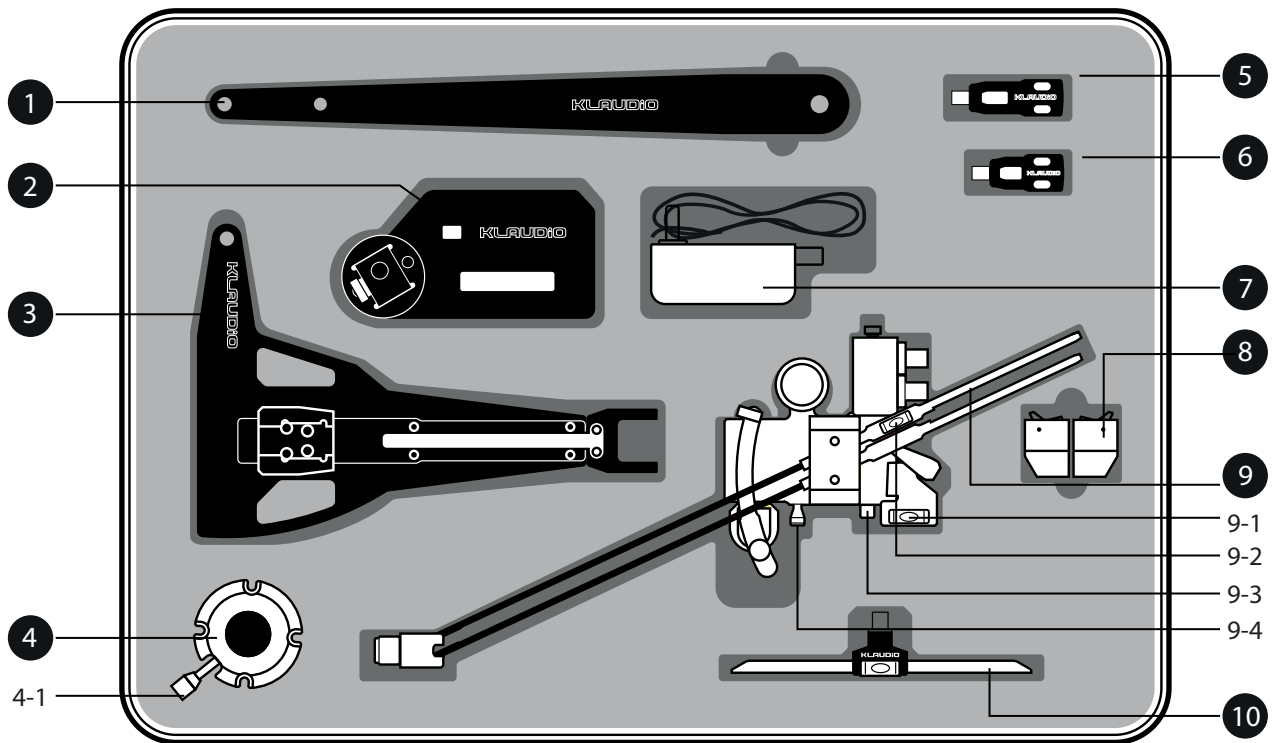

- | | | | |
|-----|---------------------------------|-----|------------------------------|
| 1 | Mounting Guide | 7 | Power Supply |
| 2 | Laser Unit | 8 | Counter Weights |
| 3 | Alignment Tool | 9 | Tonearm |
| 4 | Tonearm Base | 9-1 | Tonearm Level Bubble |
| 4-1 | Screw A (Tonearm Height Coarse) | 9-2 | VTA Level Bubble |
| 5 | Cartridge Shell (Standard) | 9-3 | Screw B (Longitudinal Set) |
| 6 | Cartridge Shell (Short) | 9-4 | Knob C (Horizontal Set) |
| | | 10 | Azimuth Tool |

Setup

I Tonearm Base Mounting

1. Adjust tonearm mounting base's position using the mounting guide.

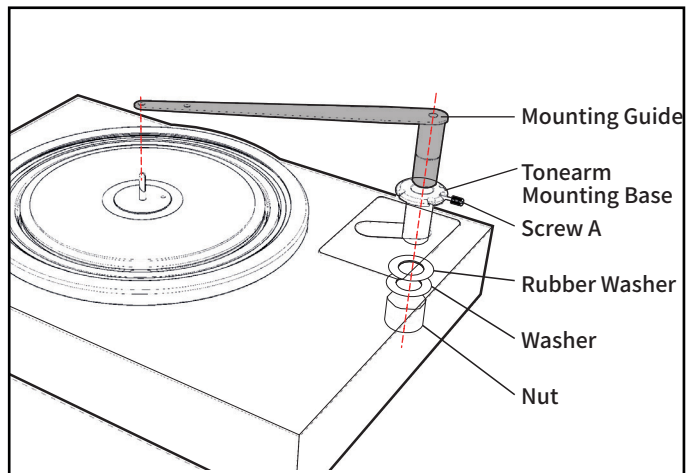

< Note >

Position screw A at about 90 degrees as shown in the diagram and tighten the nut underneath.

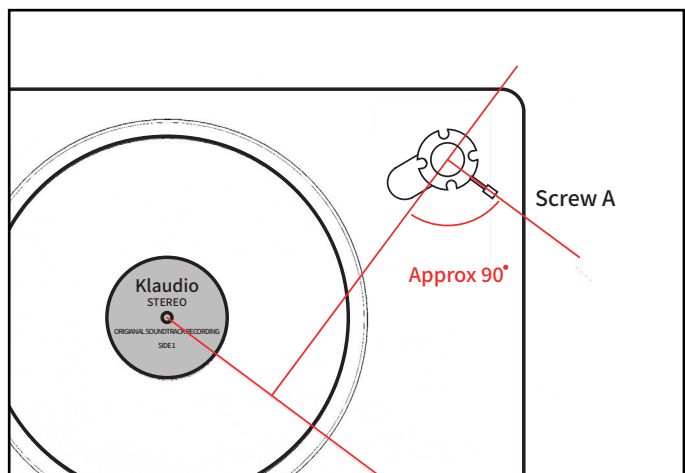

2. Insert the spring into tonearm mounting base and install tonearm body. Then attach the counterweights as shown in the diagram.

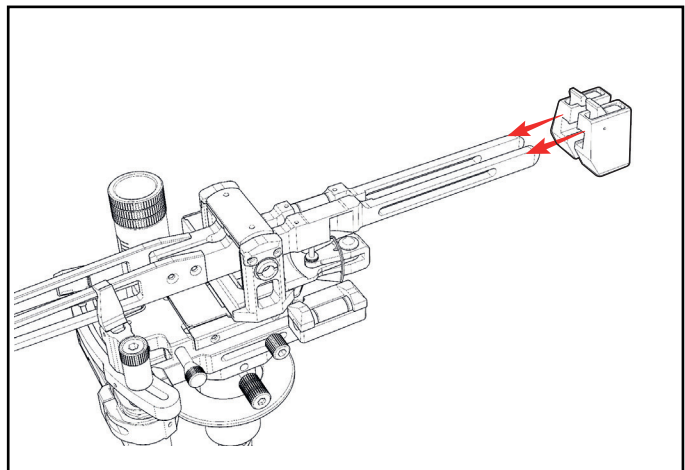

Connecting Cables

3. Connect the RCA cable and ground wire.

< CAUTION >

Hold the RCA box by hand so the tonearm is not strained while connecting the cables.

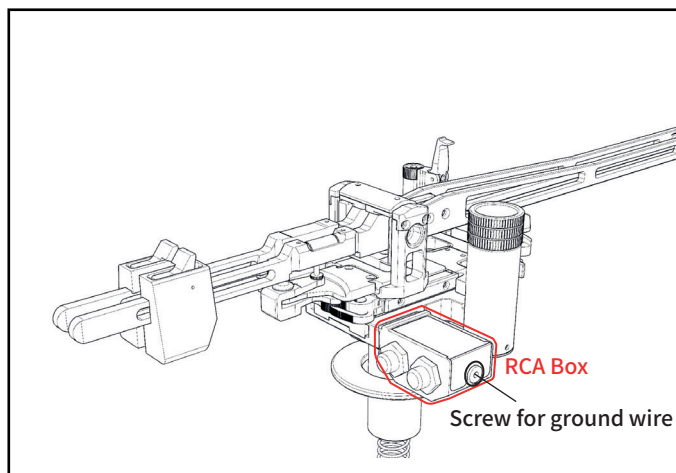

Connecting Laser

4. Remove the base plate from the laser unit and set it aside for later.

5. Connect the 7-pin connector and power cable.

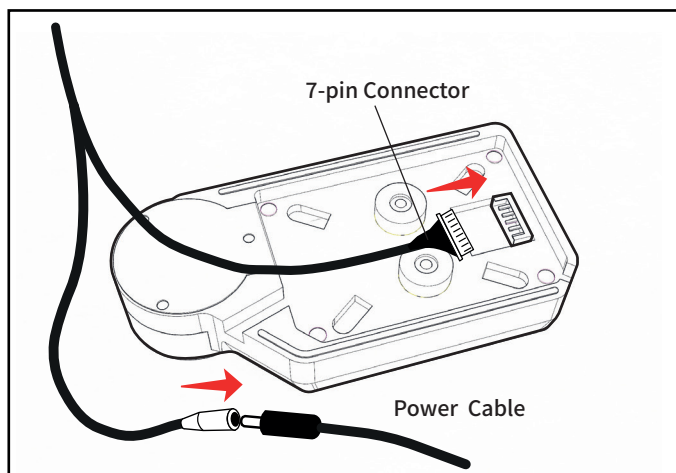

VTA Preset

6. Pre-position the VTA scale to the bottom 3mm.

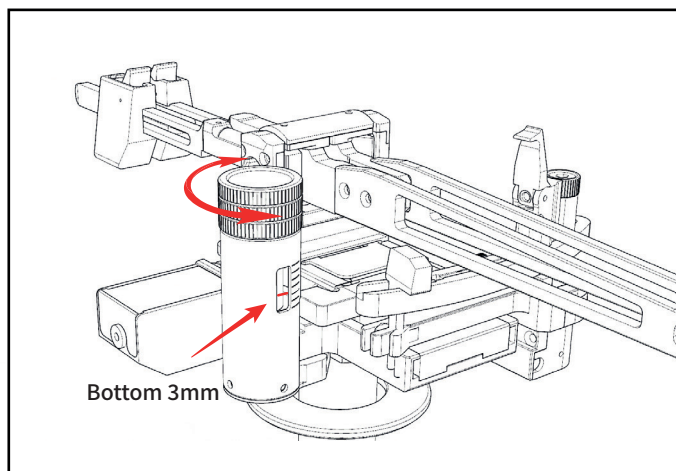

Setup

Alignment Tool Installation

7. Install the alignment tool. Hook the extension arm onto the pivot bridge.

< Caution >

Temporarily swing the arm-rest aside to avoid interference.

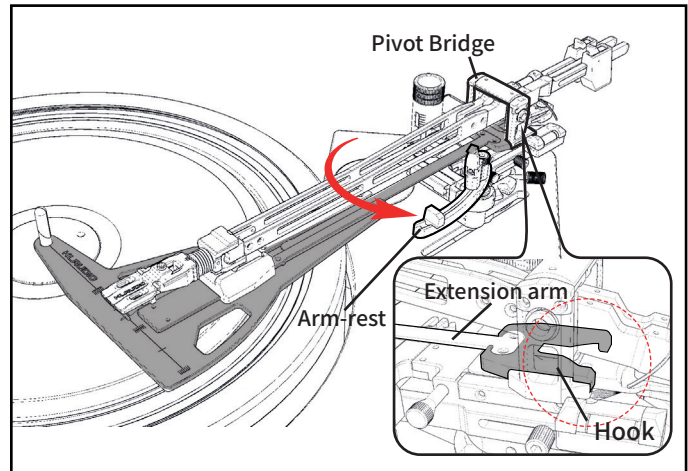

8. Put the bayonet body on the cartridge block with the cartridge.

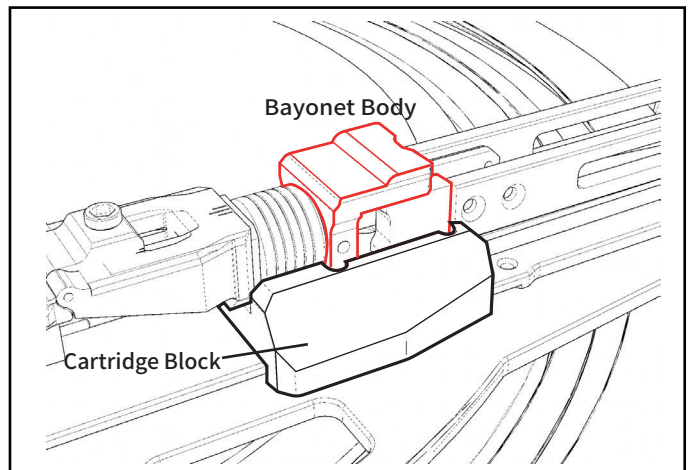

Coarse (Height) Adjustment

9-1. Press down on the center mass of the tonearm to ensure it's level with the extension arm of the alignment tool.

< Note >

Magnezar users can utilize the coarse block to adjust the height to 14-16mm.

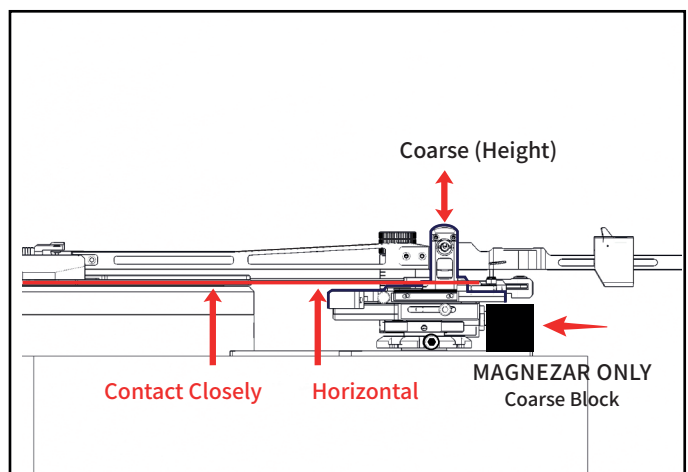

9-2.Align the cartridge center with the tool's center point, as shown in the diagram. Small adjustments can be made by manipulating the pivot bridge.

9-3.Once the coarse height and cartridge center align
Then tighten the screw A.

< Note >

Simultaneous alignment is crucial.

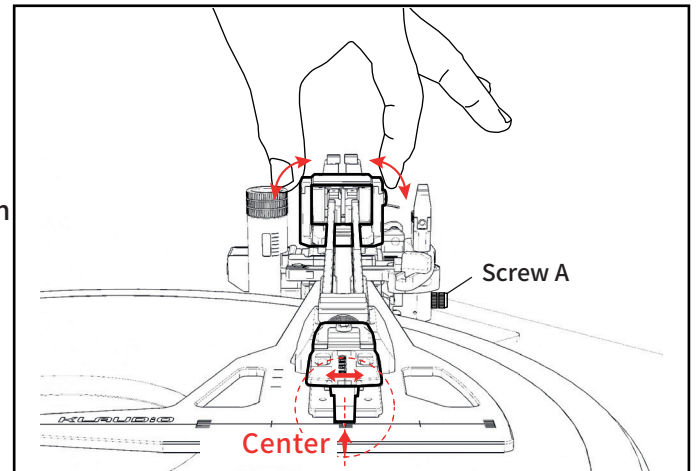

Laser Setting

10.Turn on the laser and adjust the laser unit so that it projects onto the tool's horizontal line.

11.Mark the proper position of the base plate using masking tape or an erasable pen.

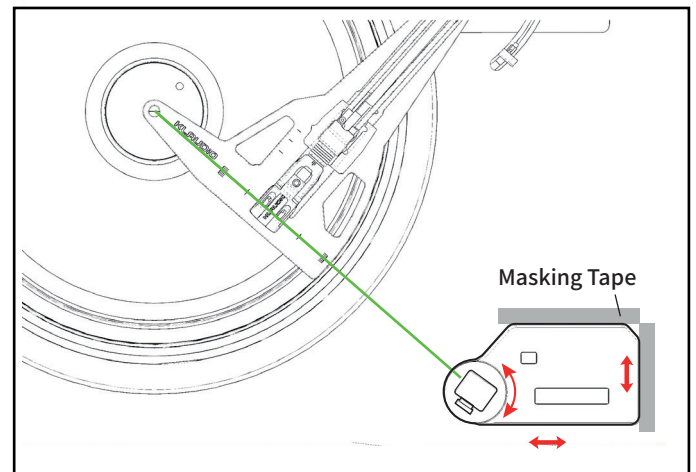

12.Peel off the double-sided tape under the laser base plate and carefully position it in the marked location.

13.Position the laser unit on top of the base plate to align the laser line with the tool's horizontal line.

14.Remove the alignment tool and temporary markings.

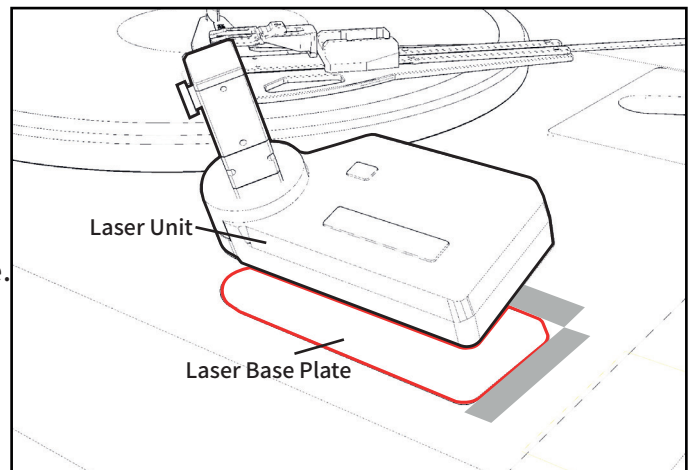

Setup

15-1. Loosen screw B

15-2. Center the tonearm level bubble by adjusting knob C.

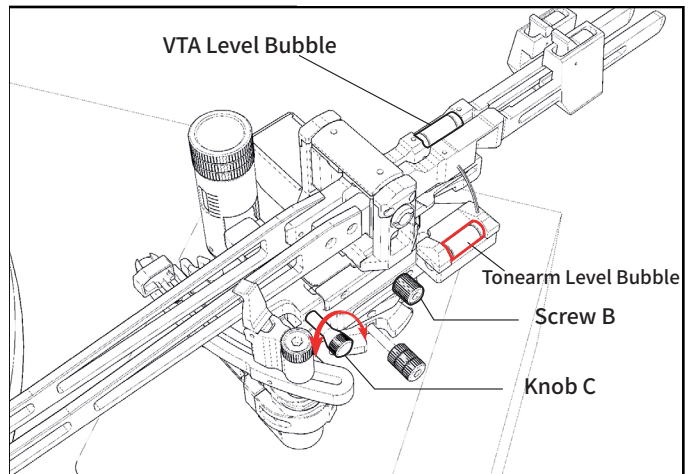

Cartridge and Laser Setting

15-3. Position the tonearm's diamond tip on the laser line.

15-4. Tighten screw B.

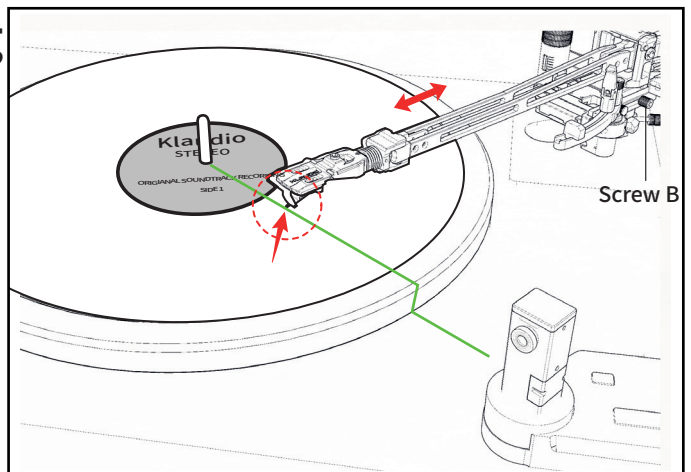

Tracking Force Setting

16. Adjust the counterweights by moving them together. Use a scale gauge to set the desired tracking force.

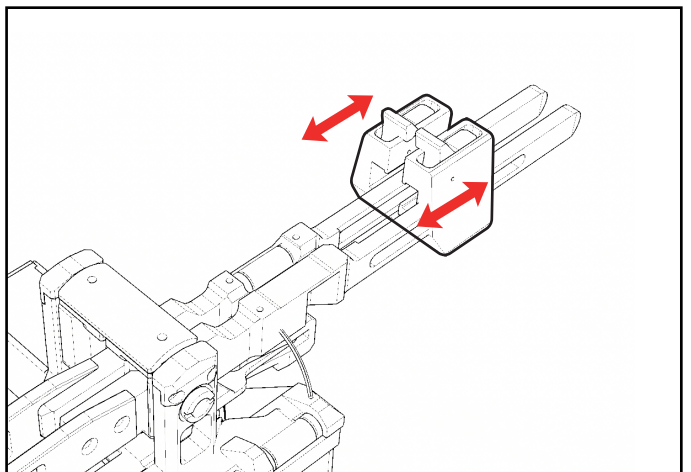

VTA Setting

17. Place an LP on the platter and lower the arm-rest to play status. Then adjust the VTA knob until the VTA level bubble is centered.

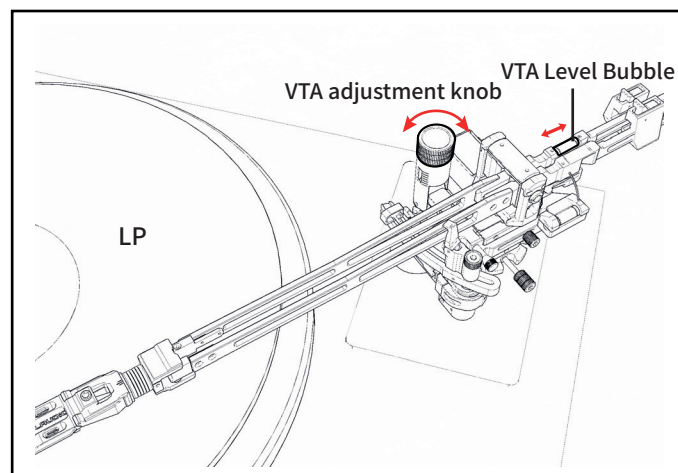

Lift Height Adjustment

18. Place the tonearm on the LP and lift the arm-rest up. Then fix the lift height using the set screw.

< Note >

We recommend setting the LP to stylus gap to about 5-10mm.

19. Setup is complete. Enjoy the music!

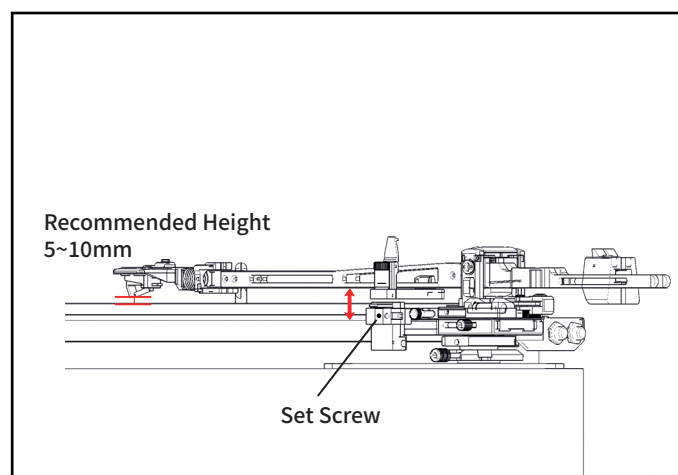

Thank you for your interest in Klaudio products.

Before using, be sure to check out the YouTube clips below to ensure proper installation and operation.



Tangential KD-ARM-AGxx Tonearms

<https://youtu.be/2wzOtc5jEqg>



Setup Guide

https://youtu.be/Dclbv_m1XbY



Anti-Drifting Steps

<https://youtu.be/zdWI7Tct2NY>



Head Shell or Cartridge Replacement

<https://youtu.be/aQIXEZqLrrc>

Limited Warranty

Klaudio ("Klaudio") warrants each new tonearm product against defects in materials or workmanship for a period of two years from the date of purchase, and agrees to repair or replace any defective Klaudio system without charge. Shipping costs are non-refundable.

This warranty is non-transferable. All warranty claims must be accompanied by the original proof of purchase.

THIS WARRANTY DOES NOT COVER DAMAGE RESULTING FROM ACCIDENT, MISUSE OR ABUSE, LACK OF REASONABLE CARE, SHIPPING DAMAGE, MODIFICATIONS, THE AFFIXING OF ANY ATTACHMENT NOT PROVIDED WITH THE PRODUCT, OR LOSS OF PARTS.

Use of chemical cleaning agents or liquids will void this warranty. Klaudio will not pay for warranty service performed by a non-authorized repair or diagnostic service and will not reimburse the consumer for damage resulting from warranty service performed by a non-authorized repair service. No responsibility is assumed for any special incidental or consequential damages due to a defective Klaudio product.