

KLAUDIO™
www.klaudio.com

KLAUDIO™



KD-CLN-LP200S
Ultrasonic Vinyl Record Cleaner
User's Manual

English v1.2

User Manuals are updated regularly. Please be sure to check our support page for a newer version of this guide: www.klaudio.com

GENERAL PRECAUTION

Please read this manual carefully before using your Klaudio product.

ABOUT SIGNS

Throughout this document, critical information is highlighted in gray-colored boxes. The following symbols are intended to help prevent any situation which may cause personal injury and/or damage to equipment:



WARNING: Indicates a potentially hazardous situation which, if not avoided, could result in personal injury or be life-threatening.



CAUTION: Indicates a potentially hazardous situation which, if not avoided, may result in damage to equipment or property.



PROHIBITED: Indicates a prohibited action.

TRADEMARKS

The Klaudio name and logo are trademarks or registered trademarks of Koolance, Inc. Other company and product names used in this publication are for identification purposes only and may be trademarks or registered trademarks of their respective companies.

COPYRIGHT

All rights reserved. Copyright (C) Klaudio.

CONTACT INFORMATION

Customer Support: tech@klaudio.com

Web: www.klaudio.com

Address: 2840 W Valley Hwy N, Auburn, WA 98001

Phone: +01 253-249-7813



CAUTION: Before powering-on the system, the “AC POWER SELECT” switch must be set for your local voltage. The incorrect setting can damage the product and is not covered by the product warranty.



CAUTION: Keep this product level whenever in operation. If the product is tilted, water may spill onto and damage the electronics.



Do not tilt or move while operating!

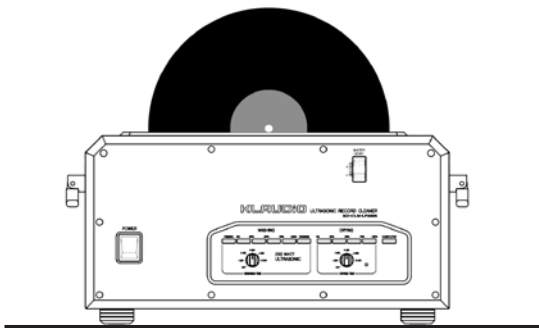

Keep unit level whenever water is inside. Always drain water from the cleaner completely before transporting.

Included Hardware

- 10mm ID Tubing
- 6mm ID Tubing
- External Pump
- Sliding Bracket for Reservoir Lid
- User Manual
- AC Power Cable (U.S. plug)

Required Tools

During installation, you may need the following tools:



flat-head screw driver



Table of Contents

Overview	1
Product Diagram	2
Features	3
Setup	4
Voltage Configuration	5
Water Sources	5
Reservoir Setup	6
Alternative Reservoirs	9
Cooling Unit Setup	10
Water Level Adjustment	11
Connecting the Power Cable	12
Adjusting Washing and Drying Settings	12
Understanding the LED Progress Bar	13
Operation	14
Loading a Record	15
Troubleshooting	16
Limited Warranty	17

Chapter 1

Overview

Product Diagram

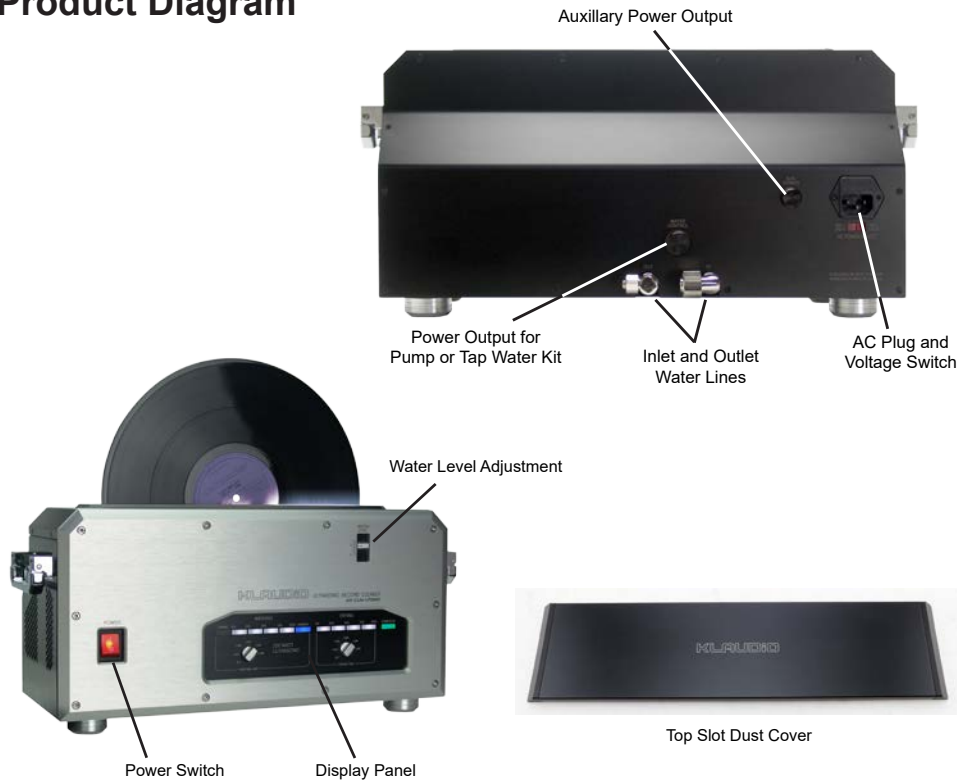

Features

Enjoy your vinyl records as if they were new again! Klaudio's KD-CLN-LP200S brings an unrivaled 200 Watts of ultrasonic cleaning power to your LP collection. Using patent-pending technology, the toughest grime and dust is easily removed without the risk of physical scrubbers or need for detergent. Drying is also handled safely with blowers. Simply connect an external water source and insert your phonograph record-- the rest is automated.

Ultrasonic transducers are placed perpendicular to the disc for maximum cleaning effect. Klaudio's technology allows powerful waves to remove debris without damaging the disc, and special dampening minimizes vibration and noise. The entire washing and drying process can be adjusted from 2 to 10 minutes. Cleaning status is conveniently displayed through an LED progress bar.

- 200W total ultrasonic cleaning power
- Compatible with 296-304mm (11.65-12in) diameter LP vinyl records (7in and 10in with separate adapters)
- Auxiliary power output for accessories
- Risk-free cleaning and drying without physical surface contact
- No scrubbing or drying rollers to replace
- Designed for use without detergent, use only distilled water (or tap water with optional kit)
- Adjustable washing time: 0-5 minutes
- Adjustable drying time: 0-5 minutes
- Wash + dry, wash-only, and dry-only modes
- 115V (60Hz) and 230V (50Hz) AC compatible
- 2-year warranty

Chapter 2

Setup

Voltage Configuration

Before powering-on the system, the “AC Power Select” voltage switch must be set for your local voltage.



CAUTION: Before powering-on the system, the “AC POWER SELECT” switch must be set for your local voltage. The incorrect setting can damage the product and is not covered by the product warranty.



On the rear of the unit, use a small flat-head screwdriver to adjust the AC voltage switch (115V/60Hz or 230V/50Hz). The incorrect setting can permanently damage the electronics. This condition is not covered by the product warranty.

Water Sources

KD-CLN-LP200S requires an external source of water for the cleaning process. There are two options: a container filled with distilled water, or a direct plumbing connection (requires optional tap water kit).



Option #1 - Reservoir Container
(Included)



Option #2 - Tap Water Kit
(Sold Separately)

Reservoir Setup

The LP cleaner must be located 8-32 inches (20-80cm) above its reservoir. It is recommended to place the cleaner on a table with the reservoir on the floor below.

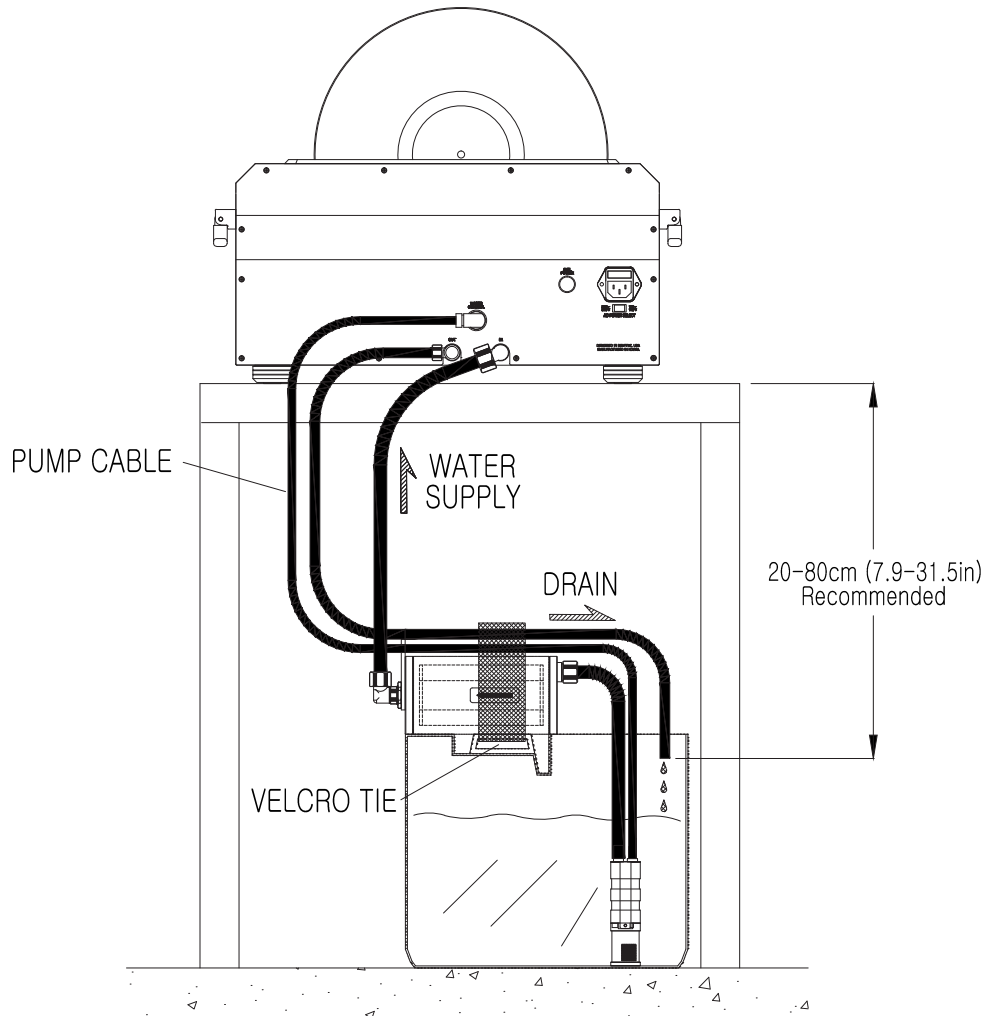

Fill the reservoir with distilled water to about 75-90%. Do not completely fill.

Do not use tap water, which can cause mineral deposits in the cleaning system. Do not add chemicals or biocides to the water, which could react with materials within the record cleaner.

To extend the period between water changes, Klaudio includes filter model KD-FLT-KIT01. This allows about 500 discs per water change. The internal filter core should be changed approximately every year, whether or not the cleaner is used.

An extra replacement filter is provided, and more are available from Klaudio. Access the filter core by unscrewing either end cap from the housing. A strap wrench can be used if needed.



Install tube fittings onto both sides of the filter.

The single elbow fitting should be placed on the filter's outlet (see directional arrow on the filter).



The LP cleaner came with two sets of tubing. Attach the larger black tubing to the pump's outlet pipe. No tubing clamp is required.



Cut this black supply tubing to about 7-inches (180mm) in length.

Connect the open end of this segment from the pump to the filter's inlet.

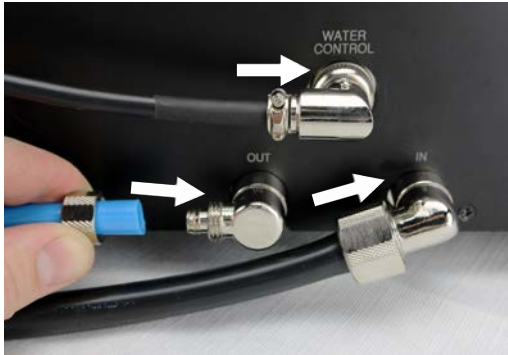

Connect the pump's power cable to the "Water Control" plug on the rear of the LP cleaner.

Connect the smaller blue drain tubing to the compression fitting labeled "Out".

Connect the unused black tubing to the compression fitting labeled "In".

Place the pump into the reservoir.



↑ To Cleaner



Connect the remaining black tubing from the cleaner to the outlet (elbow fitting) of the filter.

Fasten the filter to the reservoir's handle with the included velcro strap. The filter's inlet should face the reservoir opening.

Drop the blue drain tubing from the cleaner into the reservoir. Keep the drain tubing as straight and short as possible, and descending with no elevated sections.

Furthermore, the blue drain tubing must remain above water level inside the container. It is recommended to trim the tubing as needed, then to zip-tie it to the black supply tubing to prevent sliding.



The pump will rest at the bottom of the container. Allow enough slack in the power wire and supply tubing to achieve this.

The end of the blue drain tubing must remain above water level to speed circulation. (Therefore, the container can not be completely filled.)

The drain tubing should allow rapid water return. It should not be excessively long or loop upwards.

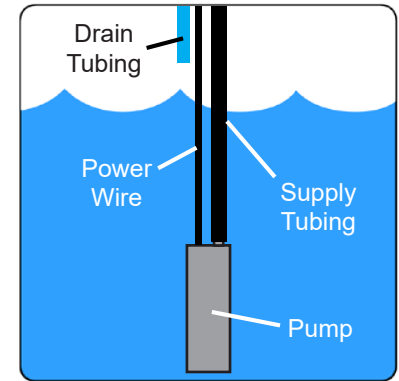

Alternative Reservoirs

Alternative containers can be used as the reservoir. The container's opening should be wide enough to accommodate the tubing and pumps. 3.75-inches (95mm) is recommended.

When using alternative reservoirs, a bracket is included to prevent the tubing and pump power lines from sliding into the reservoir.

Route both tubes and pump wire through the reservoir bracket. Each end above the bracket will be connected to the LP cleaner.

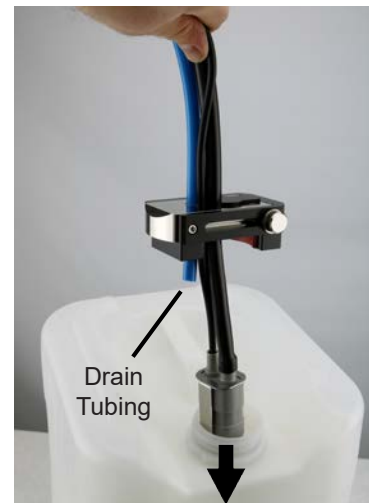

Drop the pump and connected lines into the water container.

The blue drain tubing should be shortened to remain above water level inside the container.

Keep the drain tubing as straight and short as possible, and descending with no elevated sections.

The reservoir bracket can be adjusted like a vice to grip the water container's spout. Loosen the knurled thumb screws on each side to expand or collapse the bracket.



Push the bracket together to grip the container's spout. Tighten the knurled thumb screws to hold it in place.

If your water container has no protrusion or spout to attach to, simply rest the bracket on top of the lid.

Cooling Unit Setup

KD-CLN-LP200S includes an external cooling unit to maintain the water temperature.

Place the cooling unit's pump into the reservoir.



Plug the power adapter into a wall outlet and connect the small barrel plug to the cooling unit.



The cooling unit runs automatically whenever the water temperature reaches 35°C. To check that it is functioning, hold the "Test" button to hear the fan and pump operating.

Locate the cooling unit on the floor next to the reservoir.



Water Level Adjustment



KD-CLN-LP200S features a water level adjustment for the wash basin. This is used to accommodate LP vinyl discs outside of the typical diameter range.

The water level adjustment can be particularly helpful if using the optional tap water kit. It should be calibrated for your building's water pressure.

During the washing cycle, slowly adjust the water level (observed in the top loading slot) until the LP's inner-most audio tracks are just under the water level.

Be careful, the water level will change immediately. Do not forget to lower the water level (if necessary) before the next disc, or the record label might get wet!



Connecting the Power Cable

Once the reservoir is filled with water, connect the main AC power cable to the back of the unit. Plug the pronged end into an AC outlet.



Turn on the main front power switch. It will illuminate when switched on.

Adjusting Washing and Drying Settings

Configure the setting knobs as desired. This can be done at any time before or during the cleaning operation:



“WASHING TIME” adjusts the ultrasonic washing time from 1-5 minutes. Longer cleaning times are intended for especially difficult-to-clean records. It is suggested to start with a short time period and increase if needed. If only drying is desired, select “OFF”.

“DRYING TIME” adjusts the air blower drying time from 1-5 minutes. This setting depends on room temperature and humidity. If only washing is desired, select “OFF”.



Understanding the LED Progress Bar

The LED display bar will show the current status and cleaning progress.

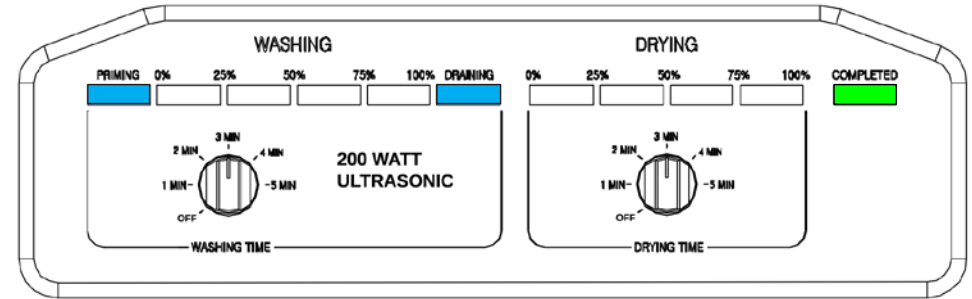

Washing Cycle

PRIMING



The pump is filling the upper wash basin from the reservoir. If flashing red, this indicates the reservoir water level is too low.

0% 25% 50% 75% 100%



Indicates the current washing progress based on the preset time.

DRAINING



The upper wash basin is emptying back into the reservoir.

Drying Cycle

0% 25% 50% 75% 100%



Indicates the current drying progress based on the preset time.

COMPLETED



Once finished, the “Completed” green LED will illuminate. The system will also emit an audio chime. Remove the disc and insert another to restart the cleaning cycle.

PRIMING



If the priming light blinks red, it indicates an operational error. Please see the “Troubleshooting” section for details.

Chapter 3

Operation

Loading a Record

After initial setup and configuration, there's only one step to operation. Carefully place an LP vinyl record with a diameter of between 296-304mm (11.65-12in) into the top loading slot. When loading, the disc should be kept vertical (perpendicular to the floor).

The cleaning/drying process will automatically start. Once finished, the "Completed" green LED will illuminate. Insert a new disc to start again.



To avoid scratches, keep disc perpendicular to the floor when inserting.

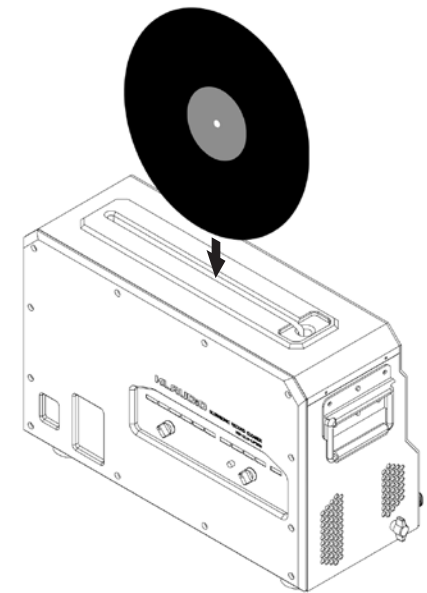

Draining and Maintenance

When using the filter, the distilled water should be replaced about every 500 discs, every few weeks, or if the water appears particularly dirty.

If the cleaner will not be used for longer than 3 weeks, the water reservoir should be emptied to dry.

Troubleshooting

1. The system does not power on, begin the cleaning cycle, or the LED progress bar flashes when a disc is inserted.

Check that the power cord is connected between the unit and an AC wall outlet. Confirm the voltage switch is properly set on the rear of the unit (See "Voltage Configuration"). Be sure the diameter of the LP record is between 296-304 millimeters (11.65-12.00 inches); other sizes will not be detected. Make sure the "Completed" green LED light is illuminated before inserting a record. If not, try power cycling the unit (turning off/on using the front power switch), then removing and reinserting the disc.

2. The priming LED light flashes red and an alarm sounds.

Single repeating beep: Insufficient water in the wash basin. Make sure the supply and drain lines are not kinked or elevated, and check the reservoir water level.

Two repeating beeps: Water temperature is above 40°C. Make sure the cooling unit's fan is spinning and allow the cleaner to cool-down before use.

Three repeating beeps: Water level is too high. Reduce the level using the front adjustment. If using the tap water kit, there may be too little or too much water being supplied to the unit. Adjust the ball valve appropriately.

3. Water is dripping from the unit.

The cleaning system must remain level at all times when in use. Also check that the tubing lines are properly connected to their fittings in back.

4. The unit makes odd noises during the washing cycle (0-100%).

The ultrasonic transducers will produce a moderate squeeling or grinding noise when cleaning, which is normal. The record is also rotated with a belt motor during this process. If a more significant noise is heard, try turning off the unit and placing it onto a different surface. Although the transducers are insulated, vibrations might be exaggerated by some table surfaces.

5. The record does not rotate properly during the cleaning or drying cycle.

This can occur if there are significant irregularities or "flat spots" in the outer edge of the disc. It may help to lightly smooth the outer edge of the vinyl with sandpaper. If sanding, rinse the disc to remove vinyl debris before inserting it into the cleaning unit.

Limited Warranty

Klaudio ("Klaudio") warrants each new ultrasonic cleaning product against defects in materials or workmanship for a period of two years from the date of purchase, and agrees to repair or replace any defective Klaudio system without charge. Shipping costs are non-refundable.

This warranty is non-transferable. All warranty claims must be accompanied by the original proof of purchase.

THIS WARRANTY DOES NOT COVER DAMAGE RESULTING FROM ACCIDENT, MISUSE OR ABUSE, LACK OF REASONABLE CARE, SHIPPING DAMAGE, MODIFICATIONS, THE AFFIXING OF ANY ATTACHMENT NOT PROVIDED WITH THE PRODUCT, OR LOSS OF PARTS .

Use of chemical cleaning agents or liquids will void this warranty. Klaudio will not pay for warranty service performed by a non-authorized repair or diagnostic service and will not reimburse the consumer for damage resulting from warranty service performed by a non-authorized repair service. No responsibility is assumed for any special incidental or consequential damages due to a defective Klaudio product.

In order to obtain warranty service, contact our RMA department for information. The product must be shipped postage prepaid to an authorized Klaudio service location. It is suggested that, for your protection, you return shipments of product by insured mail, insurance prepaid. Damage occurring during shipment is not covered by this warranty. Shipping costs are non-refundable. No other warranty, written or oral, is authorized by Klaudio.

Disclaimer

IN NO EVENT SHALL KLAUDIO, PARENT COMPANY KOOLANCE, OR ITS EMPLOYEES, AGENTS, SUPPLIERS, MANUFACTURERS, OR CONTRACTORS BE LIABLE FOR ANY DAMAGES OF ANY KIND OR CHARACTER, INCLUDING WITHOUT LIMITATION ANY COMPENSATORY, INCIDENTAL, DIRECT, INDIRECT, SPECIAL, PUNITIVE, OR CONSEQUENTIAL DAMAGES, LOSS OF USE, LOSS OF DATA, LOSS OF INCOME OR PROFIT, LOSS OF OR DAMAGE TO PERSONS OR PROPERTY, CLAIMS OF THIRD PARTIES, OR OTHER LOSSES OF ANY KIND OR CHARACTER, AND WHETHER OR NOT THE POSSIBILITY OF SUCH LOSS OR DAMAGE HAS BEEN NOTIFIED TO KLAUDIO.